

Preinsulated CPTAU lug



Spin-welded terminal lug



Crimped terminal lug

Application

This preinsulated lug is designed to connect low voltage overhead insulated conductors to copper equipment terminals. The cable sections range from 16 to 150mm² for the spin-welded terminal lug and 16 to 150mm² for the crimped lug.

Description

Spin-welded terminal lug

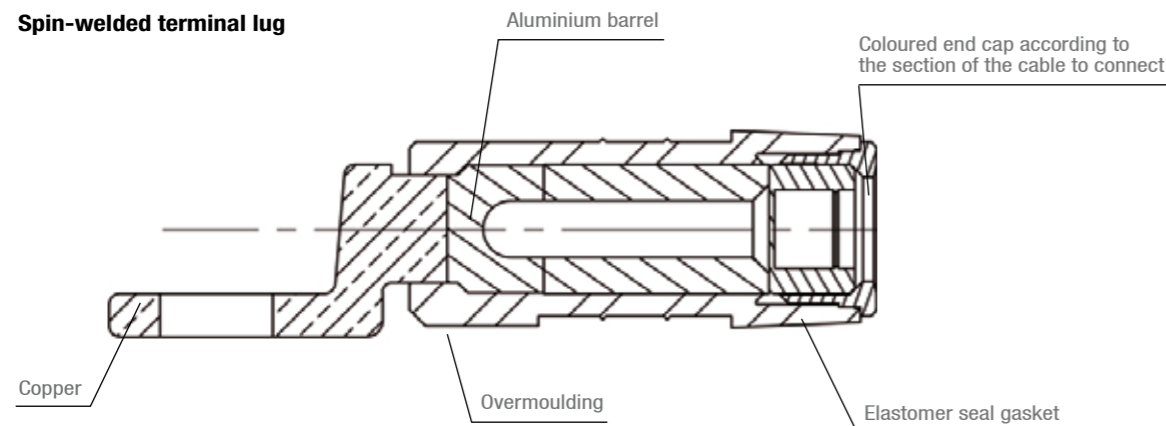

This preinsulated lug meets the requirements of the **NF C 33-021** and **EN 50-483** standards.

Crimped terminal lug

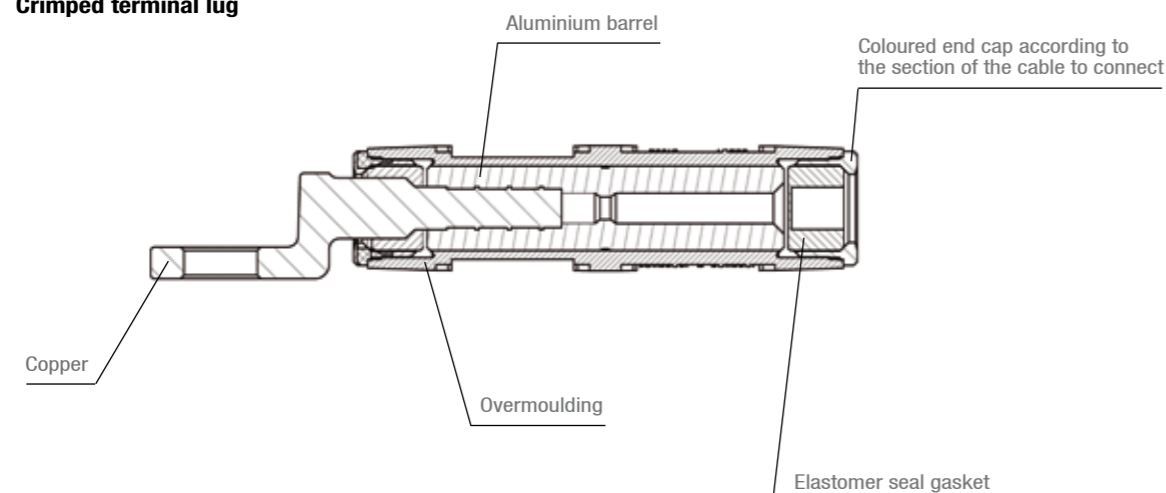

This preinsulated lug meets the requirements of the **NF C 33-021** and **EN 50-483** standards.

Installation

Crimping:

- Use a tool equipped with a suitable hexagonal die: E140 (14mm), E173 (17.3mm) or E215 (21.5mm).
- Crimp in the indicated area starting from the centre and going towards the end of the lug.

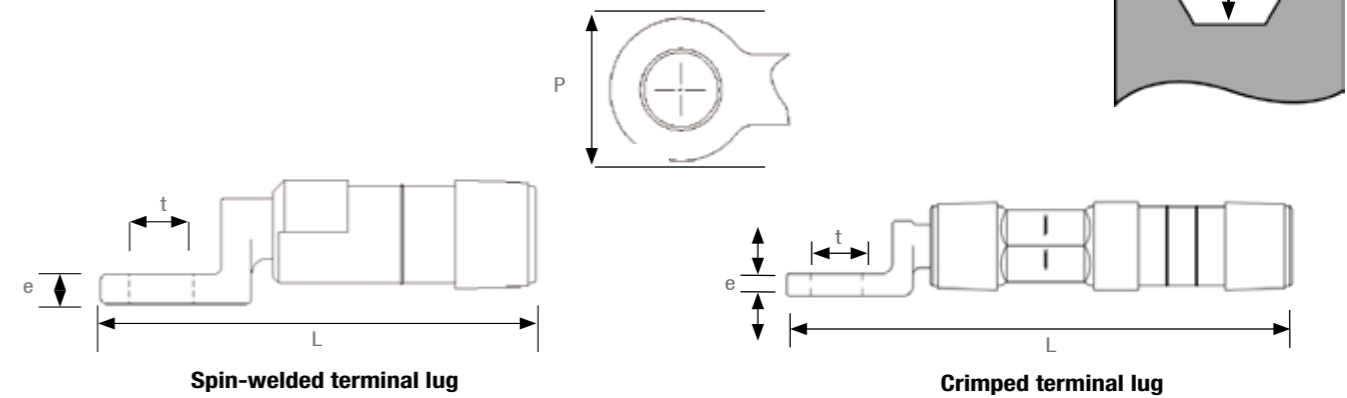

Code	Designation	Insulated Al-Cu cable (mm ²)	Dimensions in mm				Weight (kg)	Sales unit
			P	e	t	L		
SPIN-WELDED PREINSULATED LUG REQUIRING A E140 CRIMPING DIE								
K159	Cu TERMINAL LUG (E140) CPTAU 16	16	20	5	10.3	72	0.040	10
K160	Cu TERMINAL LUG (E140) CPTAU 25	25	20	5	10.3	72	0.040	10
SPIN-WELDED PREINSULATED LUG REQUIRING A E173 CRIMPING DIE								
K163	Cu TERMINAL LUG (E173) CPTAU 35	35	25	5	12.8	92	0.070	10
K164	Cu TERMINAL LUG (E173) CPTAU 50	50	25	5	12.8	92	0.070	10
K165	Cu TERMINAL LUG (E173) CPTAU 54	54	25	5	12.8	92	0.070	10
K166	Cu TERMINAL LUG (E173) CPTAU 70	70	25	5	12.8	92	0.070	10
K167	Cu TERMINAL LUG (E173) CPTAU 95	95	25	5	12.8	92	0.070	10
SPIN-WELDED PREINSULATED LUG REQUIRING A E215 CRIMPING DIE								
K024	Cu TERMINAL LUG (E215) CPTAU 150	150	30	6	12.8	118	0.120	10
CRIMPED PREINSULATED LUG REQUIRING A E140 CRIMPING DIE								
K013	Cu CRIMPED TERMINAL LUG (E140) CPTAU 25	25	20	4.5	10.5	102	0.055	10
CRIMPED PREINSULATED LUG REQUIRING A E173 CRIMPING DIE								
K017	Cu CRIMPED TERMINAL LUG (E173) CPTAU 54	54	25	5	13	142	0.120	10
K018	Cu CRIMPED TERMINAL LUG (E173) CPTAU 70	70	25	5	13	142	0.110	10
CRIMPED PREINSULATED LUG REQUIRING A E215 CRIMPING DIE								
K021	Cu CRIMPED TERMINAL LUG (E215) CPTAU 120	120	30	6	13	186	0.220	10
K023	Cu CRIMPED TERMINAL LUG (E215) CPTAU 150	150	30	6	13	186	0.220	10

SEE SHEET
INSTALLATION / Hydraulic crimping tool